

**FITTING PARTS TO TOP OF DOOR**  
PARTS FOUND IN PS.190

INTUMESCENT STUCK OVER TOP

POSITION BEARING PLATE AND ADD SCREW  
ADJUST POSITION WITH  
END GRUB AND LOCK  
OF WITH BUTTON SCREW

BUTTON

PUSH PLATE INTO  
CAVITY AND FIX  
WITH SCREWS

END GRUB

ADJUST END GRUB THRU  
THIS HOLE WITH FLAT  
HEAD SCREW DRIVER  
TO ALIGN BEARING  
WITH SHAFT IN DOOR  
FRAME

TOP OF THE DOOR

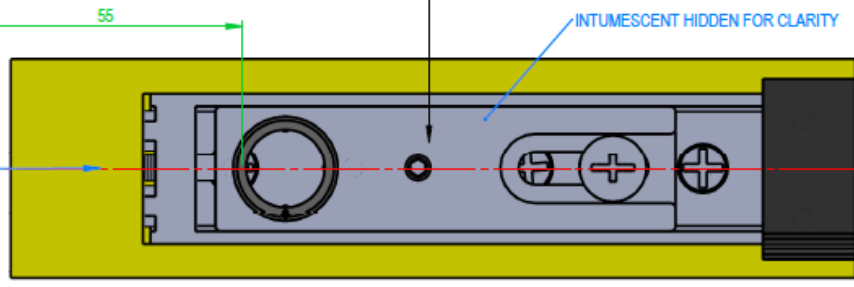
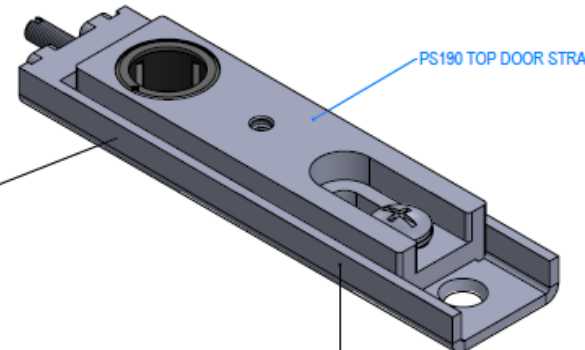
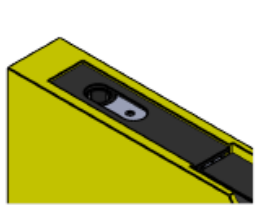

SET ADJUSTMENT  
USING FLAT HEAD  
SCREW DRIVER  
THRU HOLE IN TOP  
OF DOOR

**FITTING PARTS TO BOTTOM OF DOOR**  
PARTS FOUND IN PS.190 KIT AND IN  
INTUMESCENT PACK 12204

FIX WITH SCREWS

ADD BRASS BAR NOTE  
ORIENTATION

STICK INTUMESCENT  
INTO PLACE FIRST

BOTTOM OF THE  
DOOR

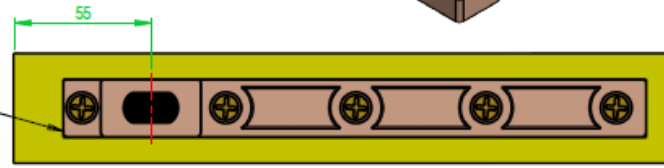
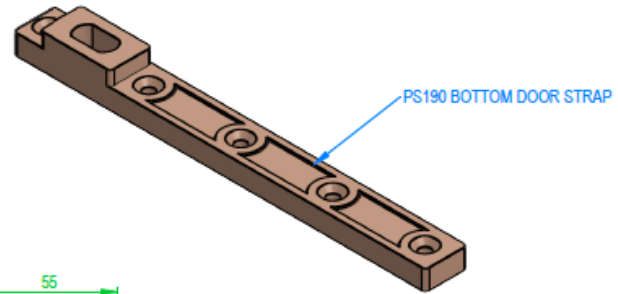
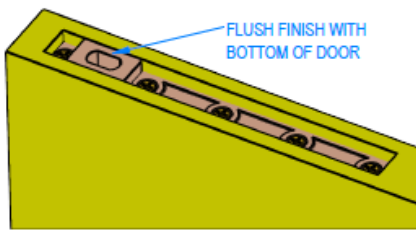

FLUSH FINISH WITH  
BOTTOM OF DOOR

C							Title: PS190
B							Contract: RUTLAND DOORS
A	01/04/20	1ST REVISION	JF	CI	CI		Drawing: RD-PS190-03
Rev	Date	Description	Drawn	Chk'd	App'd	Scale: 1:20	Requested By:

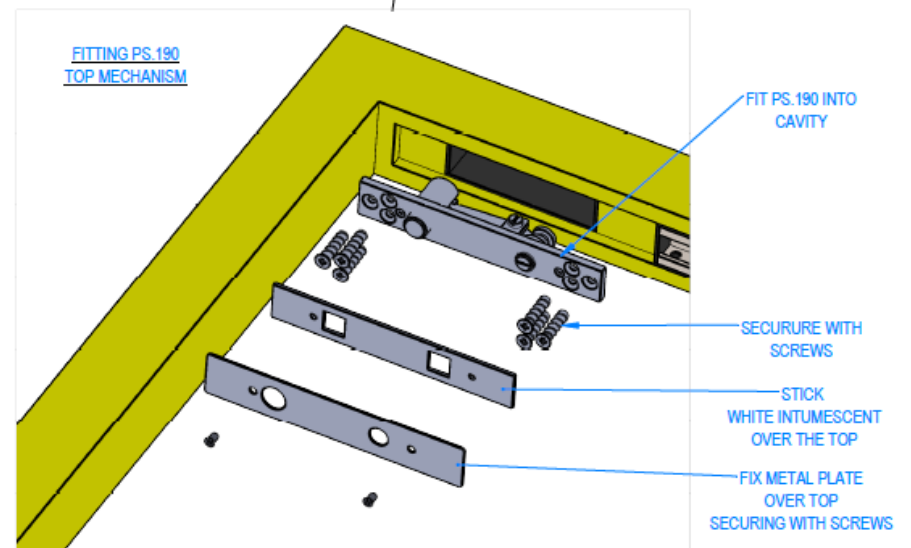
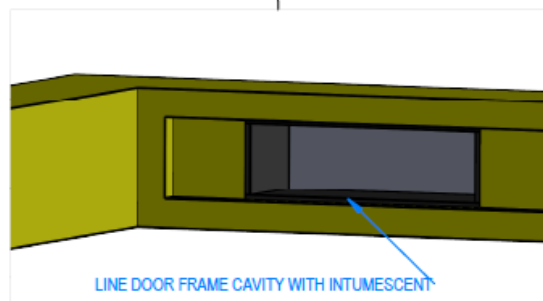
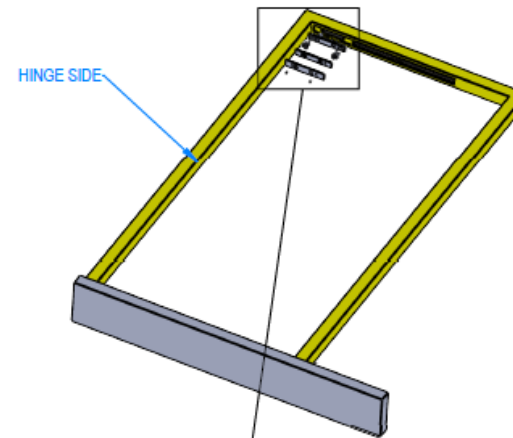
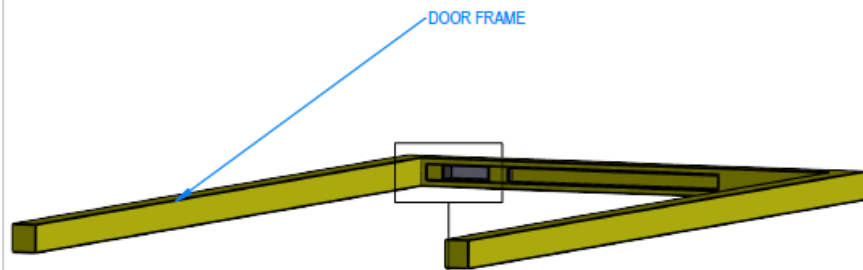

C						Title: PS190
B						Contract: RUTLAND DOORS
A	01/04/20	1ST REVISION	JF	CI	CI	Drawing: RD-PS190-04
Rev	Date	Description	Drawn	Chk'd	App'd	Scale: 1:20 Requested By:

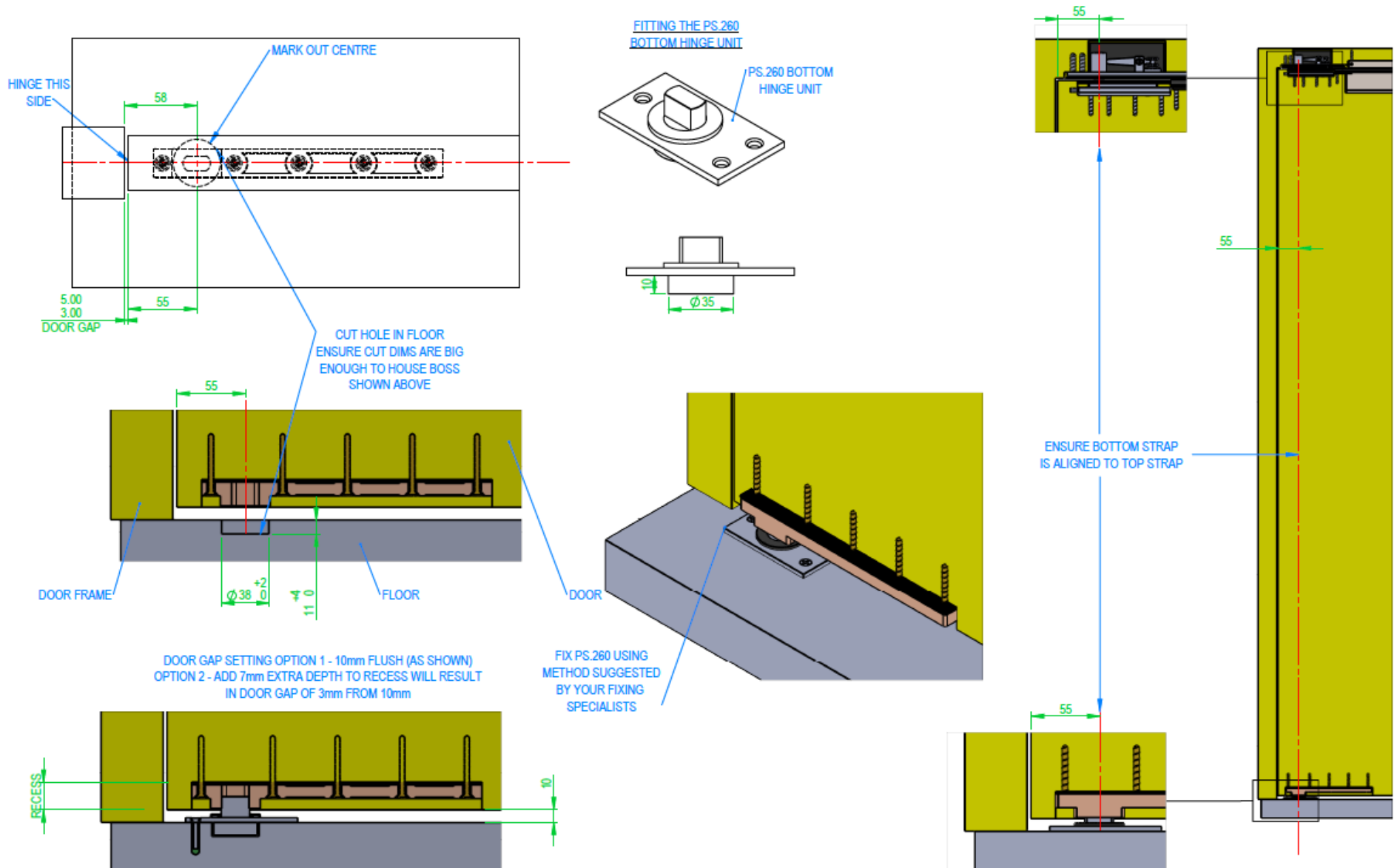

C						Title: PS190
B						Contract: RUTLAND DOORS
A	01/04/20	1ST REVISION	JF	CI	CI	Drawing: RD-PS190-06
Rev	Date	Description	Drawn	Chk'd	App'd	Scale: 1:20 Requested By: